



Itchenor Brokerage Limited
Northshore Boatyard
Itchenor
Chichester
West Sussex
PO20 7AY

www.itchenorbrokerage.com
sales@itchenorbrokerage.com

John Warne: ☎ +44 (0)7562 097230 📧 john@itchenorbrokerage.com
Adrian Webb: ☎ +44 (0)7904 600121 📧 adrian@itchenorbrokerage.com

Southerly 135RS Specification "AURELIA"



Details:

Name: AURELIA
Model: Southerly 135
Year built: 2002
HIN/CIN No: GBNYY00144C001
Builder: Northshore Yachts Ltd.
Designer: Rob Humpreys/Northshore design office
Registry: UK SSR150108
Price: £199,950.00
Tax Status: UK VAT Paid

**Itchenor Brokerage Limited**

Northshore Boatyard

Itchenor

Chichester

West Sussex

PO20 7AY

www.itchenorbrokerage.comsales@itchenorbrokerage.comJohn Warne: ☎ +44 (0)7562 097230 📧 john@itchenorbrokerage.comAdrian Webb: ☎ +44 (0)7904 600121 📧 adrian@itchenorbrokerage.com**Description**

“AURELIA” is a well maintained and well equipped Southerly 135 built in 2002 at the renowned Northshore Shipyard by Northshore Yachts Ltd. With much of the equipment upgraded over the recent years but the current owners “AURELIA” is ready to sail away. She is easily sailed by two people, with all lines being fed back to the cockpit. With the variable draft using the unique Swing Keel system going from 2’9” to 9’9” the Southerly 135 is a blue water yacht that can access shallow bays and harbours that fixed keel yachts cannot, and she can even dry out on the beach should you wish to stop for a picnic....

Dimensions

LOA: 45’6” / 13.86M

LWL: 36’6” / 11.13M

Beam: 13’6” / 4.12M

Draft (keel up): 2’9” / 0.84M

Draft (keel down): 9’9” / 2.96M

Displacement: 27,708lbs / 12,563Kgs

Grounding plate: 6,260lbs / 2,793Kgs

Swing keel: 3,610lbs / 1,637Kgs

Total Ballast: 9,770lbs / 4,430Kgs

Air Draft: 57’5” / 17.50M

Hull Construction

Heavy duty GRP moulding, hand laid up to Northshore’s laminating system, incorporating multi axial and unidirectional reinforcements. Thickness increased progressively towards the keel area. The keel box is an integral part of the hull lay-up and sandwich construction stiffening runs the entire length of the hull topsides. All main bulkheads are glassed into the hull at the main layup stage. The engine bearers are also an integral part of the hull structure.

Hull Colour: Ivory White Gelcoat

Below waterline : Clear Gelcoat

Style lines: Oxford Blue

Boot-top lines : Oxford Blue



Itchenor Brokerage Limited

Northshore Boatyard

Itchenor

Chichester

West Sussex

PO20 7AY

www.itchenorbrokerage.com

sales@itchenorbrokerage.com

John Warne: ☎ +44 (0)7562 097230 📧 john@itchenorbrokerage.com

Adrian Webb: ☎ +44 (0)7904 600121 📧 adrian@itchenorbrokerage.com

Deck Construction

Hand laid up GRP. Sandwich type construction with balsa core stiffening with plywood in high stress areas where fittings are positioned. Heavily stressed areas are additionally reinforced with unidirectional glass reinforcement. The deck is bonded to the hull through the entire length and to all main bulkheads resulting in a strong and integrated unit. Ring deck in hand laid Teak, Forward and aft coach roof decks hand laid Teak, Teak capping rail to hull to deck joint upstand
Gel Colour: Off White

Swing Keel

The fixed ballast is an iron casting which acts as a grounding plate and as transverse stiffening for the keel unit. It is fitted into a recess in the hull in the area of the keel box by means of stainless steel bolts. The aerofoil swing keel is cast iron and incorporates a stainless steel pivot at the leading edge. The swing keel is raised and lowered by a hydraulic ram powered by an electrically driven pump with a hand operated back-up. All the hydraulics are easily accessible for maintenance. The keel control and gauge showing keel position is fitted at the wheel pedestal (Replaced 2024). A removeable stainless steel pin can be positioned to enable the keel to be locked in the 'up' position. Lifting keel blade replaced and grounding plate fully refurbish in 2019. Dyneema keel pennant replaced 2024.

Engine

Yanmar 4JH3-E 56hp 4 cylinder, fresh water cooled, diesel engine fitted with a reduction/reverse gear, with 12V 60amp alternator. Engine oil/filter and fuel filter changed January 2026. Engine running hours: 1885. Bronze stern tube with water lubricated stern gland. Stainless steel propeller shaft (Shaft bearing replaced 2018, Prop shaft replaced 2020) and bronze three bladed propeller. Aquadrive propshaft coupling. Stainless steel fuel tanks with a total capacity of 80 gallons/360Ltr with sediment traps and line filter. Bronze water inlet with removable filter gauze strainer. 12V engine room ventilator, sound deadening in engine box. Automatic engine room fire extinguishing system. Removeable panels around engine box for access. Exhaust pipe replaced 2018

Thruster

75kg trust bow thruster fitted, with joystick control in cockpit (Control replaced 2019)



Itchenor Brokerage Limited
Northshore Boatyard
Itchenor
Chichester
West Sussex
PO20 7AY

www.itchenorbrokerage.com
sales@itchenorbrokerage.com

John Warne: ☎ +44 (0)7562 097230 📧 john@itchenorbrokerage.com
Adrian Webb: ☎ +44 (0)7904 600121 📧 adrian@itchenorbrokerage.com

Electrics

12 volt system. Four heavy duty batteries, charged for engine alternator: one x 140AH for engine (Replaced 2018) three x 110 Ah for domestic use (Replaced 2023). Isolating switches. Cabin lighting throughout. Reading lights over bunks. Chart light over navigation table. Full LED mast navigation light system incorporating bow lights, stern light, masthead tri-colour light with all round white anchor light, deck flood light and steaming light fitted 2019. Circuit breakers on main panel at Nav station with acrylic door cover. Windscreen wiper to starboard forward window with rocker switch at chart table area.

240v ring main system with 5 double outlet sockets (Forward cabin, saloon, galley, aft cabin and workshop). With earth leak circuit breaker and shore power connection Marlec pole mounted Rutland 1200 wind generator fitted at pushpit (New in 2023)

Navigation and Electronics

Raymarine RL70C chart plotter at chart table

Raymarine Axiom Hybrid 9" chart plotter at cockpit (Fitted new in 2020)

Raymarine Quantum digital radar scanner mounted on mast (Fitted new 2020)

Garmin GPS128

Raymarine i50/i60 speed, wind and depth display instruments above companionway hatch (Fitted 2021)

Raymarine speed wind and depth transducer (Replaced in 2022)

Raymarine ST60 Multifunction display at Chart table

Raymarine ST6001 Autopilot controls one at chart table, one in cockpit

Mastervolt Power system control panel at chart table

Mastervolt battery charger

Mastervolt inverter system

Sterling power management control panel at chart table

Sony Radio/CD player with speakers in saloon and external Sony waterproof speakers in cockpit (Fitted new in 2020)

NAV6 Navtex system

Rutland wind generator control panel (Fitted new in 2023)

Icom IC423G DSC/GPS VHF radio at chart table with Command Mic in cockpit (New in 2019)

TV aerial fitted to mast with cabling to bottom of mast (New in 2018)

Firdell radar reflector mounted at mast



Itchenor Brokerage Limited

Northshore Boatyard

Itchenor

Chichester

West Sussex

PO20 7AY

www.itchenorbrokerage.com

sales@itchenorbrokerage.com

John Warne: ☎ +44 (0)7562 097230 📧 john@itchenorbrokerage.com

Adrian Webb: ☎ +44 (0)7904 600121 📧 adrian@itchenorbrokerage.com

Engineering

Eberspacher D5LCF diesel powered hot air heating system, with 4 outlets in saloon, forward and aft cabins. Control at chart table

Holding tank system for forward head, fitted under “U” shaped saloon seating. Forwards heads can pump to sea or into tank, Aft heads can pump to sea only.

Water system and pumps

Pressurised hot and cold water system. Mixer tap to galley sink. Mixer taps in heads compartments. Fresh water hand pump fitted at galley sink. Stainless steel fresh-water tanks, total capacity 545 litres/120 gallons. Electric Jabsco fresh water pressure pump (New in 2023). Hot water provided by engine calorifier unit. Electric sump pumps to shower trays. One manual bilge pump, one electric submersible bilge pump. Transom shower with hot and cold water.

Steering Gear

Single stern rudder. Pedestal mounted 32” stainless steel cockpit wheel. Lewmar/Whitlock Mamba torque tube and bevel box system. Single lever engine control. Emergency steering system. 6” main steering compass.

Spars and rigging

Selden inmast furling rig. Double spreaders (Lower spreaders replaced 2018). Selden anodised spars finished in silver. Internal halyards. 1 x 19 stainless steel wire standing rigging with swage toggle-fork rigging screws (standing rigging replaced 2018) Furlex headsail reefing system. Single line reefing led aft to cockpit. Internal clew outhaul. Adjustable rigid, gas fitted boom vang.

Telescopic spinnaker pole with topping lift and down haul and vertical pole stowage at mast. Kicker, main halyard, topping lift, outhaul, In-mast furling. Genoa halyard at mast. Burgee and signal halyards. (Running rigging replaced 2018) 2 x Lewmar size 16T winch on mast for main(port) and genoa (starboard) Double clutched port and starboard

Sails

Sanders Sails vertically battened furling maxi-roach style mainsail for in-mast furling (4 long and 3 short vertical battens) (Fitted new 2021)

Sanders Sails furling genoa (Fitted new 2021)

Cruising chute with snuffer

Storm jib with stay fitted with lever for quick release

**Itchenor Brokerage Limited**

Northshore Boatyard

Itchenor

Chichester

West Sussex

PO20 7AY

www.itchenorbrokerage.comsales@itchenorbrokerage.comJohn Warne: ☎ +44 (0)7562 097230 📧 john@itchenorbrokerage.comAdrian Webb: ☎ +44 (0)7904 600121 📧 adrian@itchenorbrokerage.com**Cockpit**

Centre cockpit. Self-draining. Laid teak to cockpit seats and coaming. Teak grating to cockpit sole. Acrylic main sliding companionway hatch. 3 piece acrylic washboard (New fitted 2025). Instrument panels above hatchway. Two winch handle pockets. Steering pedestal with stainless steel wheel. Removeable teak cockpit table. Two safety harness eyes. Sprayhood with stainless steel, in Navy Blue canvas (Replaced with new in 2019). Cockpit Bimini with stainless steel frame in Navy Blue canvas. (Fitted new in 2020) Steering pedestal and wheel cover in Navy Blue Canvas (Replaced with new in 2024).

Deck fittings & loose equipment

Cleats forward with through bulwark fairlead. Spring and aft cleats with stainless steel chafe guards. Fairleads. Stainless steel stemhead fitting with twin bow roller. Lewmar V3 electric anchor windlass in anchor well with control in cockpit (Fitted New 2022). Stainless steel pulpits incorporating navigation light bracket. Stainless steel stanchions and guardwires, with gates port and starboard. Stainless steel pushpit with Teak seats incorporating stern gate, navigation light bracket and ensign socket. Teak outboard mounting bracket. Fuel and water deck fillers. Genoa tracks with plunger cars port and starboard. Track and traveller for mainsheet with end turning blocks and cleats for traveller lines. Mast step incorporating blocks for leading halyard and reefing lines back over coachroof. Mainsheet track with control lines on each side, for running rigging. Two Lewmar 30ST winches on coachroof port and starboard for lines for mast. Two Lewmar 48ST winches on cockpit coamings for genoa sheets. Two mooring cleats on aft deck. Two lazarette lockers with gas stowage ventilated overboard. Scoop stern with bathing platform. Stern stainless steel boarding ladder. Deck shower in transom. Stainless steel grab handles on either side of coachroof. Simpson dinghy davits fitted to transom (Fitted new in 2020) . 20Kg Delta anchor. 60 Metres of 10mm chain (new in 2022). 30 Metres of rope warp (New 2022). Three fire extinguishers. One fire blanket. 1 x 10" lock in winch handles. Liferaft with stainless steel mounting cradle mounted on pushpit



Itchenor Brokerage Limited

Northshore Boatyard

Itchenor

Chichester

West Sussex

PO20 7AY

www.itchenorbrokerage.com

sales@itchenorbrokerage.com

John Warne: ☎ +44 (0)7562 097230 ✉ john@itchenorbrokerage.com

Adrian Webb: ☎ +44 (0)7904 600121 ✉ adrian@itchenorbrokerage.com

Windows, hatches and ventilation

Two opening deck hatches, Lewmar size 60, over forecabin and aft cabin. Four opening hatches in coachroof, Lewmar size 20, over saloon, galley, chartable and midships cabin. Glazed opening ports in aft cabin coamings, port and starboard. Four dorade and three fixed ventilators on deck serving forward heads, saloon, and aft cabin. Acrylic main companionway hatch. Pilot house windows and hull ports are partially reflective toughened glass, bonded into recesses in the GRP mouldings.

Internal joinery and upholstery

Interior joinery is finished in Solid Teak and Teak faced marine quality plywood. Linings are fabric covered or GRP as appropriate. Cabin soles are teak and holly striped laminate plywood.

Upholstery

Saloon and sleeping cabins – Blue (Replaced 2018)

Navigators seat – Alcantara 7912

Curtains: Lower areas (Replaced 2019)

Concertina blinds: Raised saloon (Replaced 2020)

Galley surface: Formica Polyray 94/95 063 Surf

Heads surfaces: Nordstone moulding – Sapphire GE152

Accommodation

There are a total of nine potential sleeping berths with two in the forecabin, , four in the saloon (comprising of two on the U shaped saloon seating, one on the single settee and one on the hammock above), one in the midships sea berth and two in the aft cabin.

GALLEY

Twin stainless steel sinks

Laminated worktops

Pressurised hot and cold water

Extended stainless steel crash grabrail for cooker and worktops

Cool box with top access (not refrigerated)

Stainless steel refrigerator with small ice box

Fully gimballed gas cooker, Plastimo 2000 with two burners, grill, and oven (Fail-safe devices on all burners)

Gas cut off tap

Pull out storage rack with 3 shelves to port



Itchenor Brokerage Limited

Northshore Boatyard

Itchenor

Chichester

West Sussex

PO20 7AY

www.itchenorbrokerage.com

sales@itchenorbrokerage.com

John Warne: ☎ +44 (0)7562 097230 📧 john@itchenorbrokerage.com

Adrian Webb: ☎ +44 (0)7904 600121 📧 adrian@itchenorbrokerage.com

4 drawer unit facing forward

Bin area below sink

Twin deep storage cupboards facing aft

Large under floor storage compartment

Three opening portlights

One hull port

SALOON

U shaped dinette seating to port, which convert to double berth

Two seater settee to starboard, converts to 2 small singles, bunk style arrangement with pipe cot arrangement and with lee cloths

Excellent vision

Extending folding leaf pedestal table

Stowage

Bookshelf

Oilskin stowage

Opening hatch

NAVIGATION AREA

Forward facing full size chart table

Swivelling navigator's seat on adjustable pedestal in blue leatherette

Excellent vision

Instrument console forward of the chart table

Chart stowage

Locker spaces

Open hatch over

Chart light

Night light overhead and at floor level

Main switch panel

MIDSHIPS SETTEE/BERTH

Single settee/berth to starboard

Storage below and outboard

Opening hatch

Two hull ports

Curtains to hull ports



Itchenor Brokerage Limited

Northshore Boatyard

Itchenor

Chichester

West Sussex

PO20 7AY

www.itchenorbrokerage.com

sales@itchenorbrokerage.com

John Warne: ☎ +44 (0)7562 097230 📧 john@itchenorbrokerage.com

Adrian Webb: ☎ +44 (0)7904 600121 📧 adrian@itchenorbrokerage.com

AFT CABIN

Large central double berth with coil sprung mattress (Replaced 2019)

Seating either side

Vanity unit

Chest of drawers

Hanging lockers

Opening hatch

Four opening portlights

Dorade ventilators

Curtains to portlights

Access to steering gear from under berth

AFT CABIN ENSUITE

Lavac marine toilet (Replaced 2020)

Washbasin with Nordstone surround

Hot and cold pressurised water

Shower

Electric shower tray sump pump

Grating to shower tray

Lockers

Mirror

Glass holder

Two opening portlights

Ventilation through cockpit coamings

WORKSHOP

Access from aft cabin ensuite and through cockpit locker

Workbench

Stowage below

Hatch for cockpit access

FORECABIN

“V” berth, two long single berths with infill cushion to covert to double.

3 drawer unit to starboard with tabletop and small cupboard above

Stowage under berths



Itchenor Brokerage Limited

Northshore Boatyard

Itchenor

Chichester

West Sussex

PO20 7AY

www.itchenorbrokerage.com

sales@itchenorbrokerage.com

John Warne: ☎ +44 (0)7562 097230 📧 john@itchenorbrokerage.com

Adrian Webb: ☎ + 44 (0)7904 600121 📧 adrian@itchenorbrokerage.com

Overhead lockers forward

Opening Hatch

Two opening portlights

Two hull ports

Curtains to hull ports and portlights

FORWARD HEADS

Lavac Marine toilet

Wash basin with Nordstone surround

Hot and cold pressurised water

Shower

Grating to shower tray

Electric shower tray sump pump

Locker

Mirror

Glass holder

Dorade ventilator

Opening portlight

MIDSHIPS CABIN

Single bunk berth with lee cloth

Hanging locker

Stowage under lower berth

Opening hatch

Opening portlight

Two hull ports

Dorade ventilator

Curtains to hull ports and portlight



Itchenor Brokerage Limited
Northshore Boatyard
Itchenor
Chichester
West Sussex
PO20 7AY

www.itchenorbrokerage.com
sales@itchenorbrokerage.com

John Warne: ☎ +44 (0)7562 097230 📧 john@itchenorbrokerage.com
Adrian Webb: ☎ +44 (0)7904 600121 📧 adrian@itchenorbrokerage.com

STANDARD INTERIOR LAYOUT

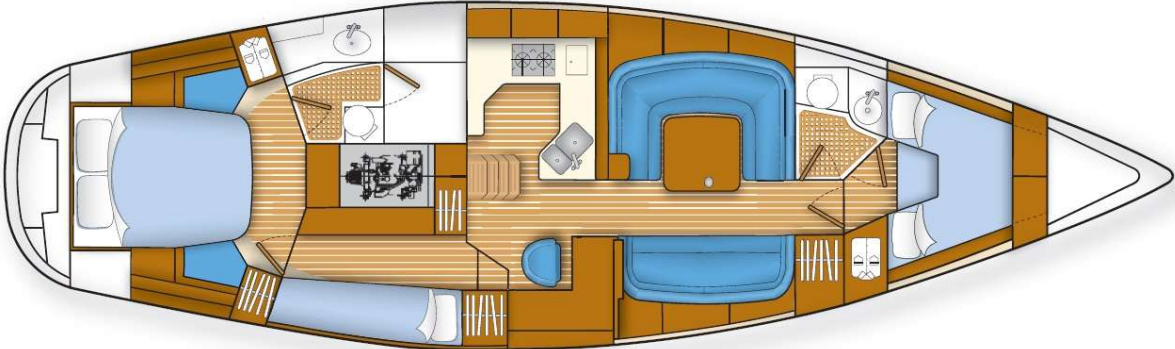

Disclaimer

The company offers the details of any vessel or equipment shown on this website in good faith but cannot guarantee or warrant the accuracy of this information nor warrant its condition. A buyer should instruct his agents, or his surveyors, to investigate such details as the buyers desires validated.

All vessels are offered subject to prior sale, price change, or withdrawal without prior notice.