



**Itchenor Brokerage Limited**

Northshore Boatyard

Itchenor

Chichester

West Sussex

PO20 7AY

[www.itchenorbrokerage.com](http://www.itchenorbrokerage.com)

[sales@itchenorbrokerage.com](mailto:sales@itchenorbrokerage.com)

John Warne: ☎ +44 (0)7562 097230 📧 [john@itchenorbrokerage.com](mailto:john@itchenorbrokerage.com)  
Adrian Webb: ☎ + 44 (0)7904 600121 📧 [adrian@itchenorbrokerage.com](mailto:adrian@itchenorbrokerage.com)

## **Southerly 115**



**Vessel Name:** GREHAN

**Price:** £60,000.00

**Year of Build:** 1992

Itchenor Brokerage Ltd., Company No. 16230088  
Registered office address: 71-75 Sheldon Street, Covent Garden, London, WC2H 9JQ  
Southernly Marine is a registered trademark of Itchenor Brokerage Ltd

**Itchenor Brokerage Limited**

Northshore Boatyard

Itchenor

Chichester

West Sussex

PO20 7AY

[www.itchenorbrokerage.com](http://www.itchenorbrokerage.com)[sales@itchenorbrokerage.com](mailto:sales@itchenorbrokerage.com)

John Warne: ☎ +44 (0)7562 097230 📧 [john@itchenorbrokerage.com](mailto:john@itchenorbrokerage.com)  
Adrian Webb: ☎ + 44 (0)7904 600121 📧 [adrian@itchenorbrokerage.com](mailto:adrian@itchenorbrokerage.com)

**Builders:**

Northshore Yacht Yards Ltd, Itchenor, Chichester, West Sussex PO20 7AY

**Designer:**

Dick Carter &amp; Northshore in-house design team.

**Description:**

The Southerly 115 has proved to be the ideal cruising yacht for many owners. The key to any Southerly's success is the unique Swing Keel, a concept originated and developed by Northshore. With the twin benefits of extreme shoal draft and uncompromised performance in deeper water, the Swing Keel makes the Southerly 115 one of the most versatile cruising yachts afloat. The open plan interior layout is a much loved feature of the Southerly range, providing spacious living accommodation with a central galley serving the saloon and cockpit. Owners and their crews enjoy the convenience of this and the raised galley and inside piloting position, which enables them to keep watch from the comfort and warmth of the deck house.

**Dimensions:**

LOA	36'11"	11.25M
LWL	27'6"	8.38M
BEAM	11'11"	3.62M
DRAFT (Keel Up)	2'3"	0.69M
DRAFT (Keel Down)	8'1"	2.46M
DISPLACEMENT	15,215lbs	6900Kg
BALLAST WEIGHT	4,962lbs	2250Kg
KEEL WEIGHT	2,635lbs	1195Kg
FUEL TANK	50 Gallon	225 Litre
WATER TANK	60 Gallon	270 Litre
HOLDING TANK	19 Gallon	86 Litre

**Construction:**

Hull and superstructure are heavy duty hand lay-up GRP mouldings. In the hull, woven rovings and chopped strand mat are used in combination with thickness increasing progressively towards the keel area. There is a balsa core in the topsides that stops just above the waterline. The deck is of sandwich type construction using balsa core stiffening, with plywood in high stress areas where fittings are positioned. Bulkheads

**Itchenor Brokerage Limited**

Northshore Boatyard

Itchenor

Chichester

West Sussex

PO20 7AY

[www.itchenorbrokerage.com](http://www.itchenorbrokerage.com)[sales@itchenorbrokerage.com](mailto:sales@itchenorbrokerage.com)

John Warne: ☎ +44 (0)7562 097230 📧 [john@itchenorbrokerage.com](mailto:john@itchenorbrokerage.com)  
Adrian Webb: ☎ + 44 (0)7904 600121 📧 [adrian@itchenorbrokerage.com](mailto:adrian@itchenorbrokerage.com)

are glassed in, and the entire deck is bonded to the hull resulting in a strong and integrated unit. A teak rubbing strake is fitted externally. The interior joinery is of American Cherry faced plywood, with solid wood trims built onto GRP base modules which are also “glassed” into the hull.

Hull colour: Off-White

Deck colour: Off-White

Boot-top and style lines: Dark Blue

Underwater: Blue antifouling

**Swing keel:**

The cast iron grounding plate is bolted into a recess in the hull using stainless steel bolts. It acts as transverse stiffening in way of the keel slot and protects the hull when taking the ground. The aerofoil swing keel is cast iron with a stainless steel pivot fitting into a substantial boss at the forward end of the grounding plate. The swing keel is raised by a Electrically operated single ram hydraulic system which is attached to the swing keel by a pulley system. The keel pennant was replaced with new in 2021,

**Engine:**

Yanmar 3HM35 34HP 3 cylinder 4 stroke marine diesel fitted with reverse/reduction gear. A marine electrical system with a 50amp alternator is fitted. Yanmar de Luxe instrument panel. Other fittings include bronze stern tube with water lubricated stern gland, stainless steel propeller shaft and a Featherstream feathering propeller, with bronze hub and stainless steel blades. Ambassador rope cutter. Steel fuel tank, capacity approx. 50 gallons, with sediment trap, sight gauge and line filter. Bronze water inlet with strainer. Sound insulation in engine compartment. Single lever engine control both in the helmsman’s position and in the wheelhouse. Extractor fan in engine compartment.

**Bowthruster**

Sleipner Side Power 55hp electric bow thruster, with control in cockpit.

**Steering Gear:**

The cockpit wheel is pedestal mounted. A torque tube system connects the wheel to the steering arm. Steering system fully service April 2022. Raymarine autopilot joystick. The rudder is a GRP moulding protected by a shoe to facilitate beaching or sailing in shallow water. An emergency tiller is supplied.

**Itchenor Brokerage Limited**

Northshore Boatyard

Itchenor

Chichester

West Sussex

PO20 7AY

[www.itchenorbrokerage.com](http://www.itchenorbrokerage.com)[sales@itchenorbrokerage.com](mailto:sales@itchenorbrokerage.com)

John Warne: ☎ +44 (0)7562 097230 📧 [john@itchenorbrokerage.com](mailto:john@itchenorbrokerage.com)  
Adrian Webb: ☎ + 44 (0)7904 600121 📧 [adrian@itchenorbrokerage.com](mailto:adrian@itchenorbrokerage.com)

**Spars:**

Mast and boom are anodised aluminium alloy with stainless steel and alloy fittings. The boom has mainsail slab reefing and a solid boom vang. Furling headsail reefing system. Telescopic spinnaker/whisper pole. Rid kicker with control line led aft

**Rigging:**

Standard rigging of 1 x 19 stainless steel wire with swaged end fittings and stainless steel rigging screws. Running rigging in terylene or equivalent. The main and genoa halyards are on the mast with two Lewmar 8 halyard winches. Furllex headsail reefing system lead aft through stanchion mounted fairleads, Kemp drum furling in-mast mainsail reefing, with inhaul and outhaul led aft to the cockpit with mainsheet to two Lewmar winches.

**Sails:**

Maxiroach vertically battened mainsail. Maxiroach fully battened furling genoa. Cruising chute with snuffer. Spinnaker with snuffer.

**Windows and Hatches:**

Lewmar hinged acrylic deck hatch forward. Main companionway hatch in GRP on slides with garage. Lewmar hinged acrylic hatch in aft cabin on poop deck. Opening deck hatch over Galley. Opening windows in aft cabin and aft toilet. Dorade vent over saloon. Ventilators in toilet and galley. All other windows are fixed tinted polycarbonate or acrylic panels, except for the forward facing wheelhouse windows which are toughened glass.

**Cockpit:**

Integral with deck mouldings. Cave lockers in coamings. Large cockpit locker with access to drained gas bottle stowage. 30" stainless steel wheel on pedestal with binnacle compass. Wheel and pedestal cover in blue canvas.. Cockpit seats, coamings and aft deck are teak laid. Cockpit sole has teak grating. Cockpit is drained with 2 x 2" bore pipes. Sprayhood, cockpit cover and bimini in blue canvas with stainless steel frames.

**Freshwater:**

60 gallons approximately. Stainless steel tank with deck filler. Electric pressure system pump and engine calorifier for hot water feeding galley and washbasins.

**Itchenor Brokerage Limited**

Northshore Boatyard

Itchenor

Chichester

West Sussex

PO20 7AY

[www.itchenorbrokerage.com](http://www.itchenorbrokerage.com)[sales@itchenorbrokerage.com](mailto:sales@itchenorbrokerage.com)

John Warne: ☎ +44 (0)7562 097230 📧 [john@itchenorbrokerage.com](mailto:john@itchenorbrokerage.com)  
Adrian Webb: ☎ + 44 (0)7904 600121 📧 [adrian@itchenorbrokerage.com](mailto:adrian@itchenorbrokerage.com)

**Bilge Pump:**

2 electric bilge pumps below decks

**Electrics:**

Three heavy duty AGM 12 volt batteries fitted with isolator/changeover switches, one for engine start and two for domestic. Sterling battery charger, running from 240V shorepower. Sterling battery management panel. Engine alternator with Sterling charge boost system fitted to maximise charge output. Full accommodation and navigation lights. Combined flood light and steaming light on mast and combined tri-colour all round white light at masthead. Switch panel at chart table with switch circuit breakers to protect systems.

12v socket fitted at chart table. USB charging point at chart table. 240V shore power supply with ring main. 240V immersion heater fitted to engine calorifier. Sacrificial anode on hull connected to engine and sterntube. Solar panel BP365J mounted on davits, with regulator fitted in engine compartment. Full navigation light system, masthead tricolour navigation light, masthead anchor light, steaming light, foredeck flood light, deck level navigation lighting set.

**Deck Fittings:**

Lewmar mainsheet track with car and traveller, positioned on coach roof in front of sprayhood, with control lines led aft. Lewmar fore and aft genoa tracks with plunger cars. Spinlock clutches fitted port and starboard of main hatch for halyards and control lines. 2 speed Lewmar 44 self tailing primary winches. 2 Lewmar 16 single speed winches for halyards/control lines. Lewmar Pro series 1000 12 volt reversing anchor windless with remote control on foredeck. Fairleads. Fore, aft, and mid-ship mooring cleats. Stainless steel stanchions and double lifelines, with gates for port and starboard. Stainless steel pulpit and split pushpit. Bow roller fairlead incorporating stowage for anchor. Furlex headsail gear. Stainless steel transom ladder. Whittall SM07 davits. Teak grabrails port and starboard on aft cabin coachroof deck. Outboard engine stowage bracket fitted to pushpit. Folding stainless steel boarding ladder fitted to transom.

**Electronics & Navigation:**

Steering compass mounted on pedestal. Raymarine ST60 wind, speed and depth instruments fitted in GRP pod, with ST60 multi-repeater at chart table. Raymarine RD418D digital Raydome fitted to mast, radar reflector fitted to mast. Hawk wind indicator fitted to masthead. Raymarine C90W display interfaced with C90W display at

**Itchenor Brokerage Limited**

Northshore Boatyard

Itchenor

Chichester

West Sussex

PO20 7AY

[www.itchenorbrokerage.com](http://www.itchenorbrokerage.com)[sales@itchenorbrokerage.com](mailto:sales@itchenorbrokerage.com)

John Warne: ☎ +44 (0)7562 097230 📧 [john@itchenorbrokerage.com](mailto:john@itchenorbrokerage.com)  
Adrian Webb: ☎ + 44 (0)7904 600121 📧 [adrian@itchenorbrokerage.com](mailto:adrian@itchenorbrokerage.com)

internal steering position with AIS overlay to plotter. Raymarine 49E VHF radio telephone with DSC, with cockpit speaker, separate handset plugs in at pedestal. Raytheon ST6000 with Whitlock Mamba rotary drive and autopilot. Garmin GPS Navigator. AM/FM stereo radio with CD player.

**Engineering:**

Holding tank system fitted, heads pumps to sea or tank for shore pumpout.  
Gas fuelled warm air heating system

**Inventory:**

20Kg Bruce anchor with 30M calibrated 8mm chain. Secondary 10Kg Delta anchor with 4M non calibrated chain plus warp. Mooring warps. Fenders. Fire extinguisher. Fire blanket.  
Flag staff and boathook. 4 man liferaft (New 2019), Danbuoy. Horseshoe lifebuoy with light,

**Accommodation:**

Generally in accordance with the GA. Interior joinery in American Cherry

**Fore Cabin**

Two full size overlapped berths with stowage under. Stowage for table extension with shelves. Access to chain locker. Opening Lewmar hatch giving access to foredeck. 2 hull ports with teak rails and curtains. Door to main saloon.

**Saloon**

Adjustable height table converts dinette to double berth. Lockers under dinette with shelf and drinks stowage behind. Teak bookshelf above hull windows. Settee/berth opposite dinette with bookshelf behind. 2 opening deck hatches. Floor covering is teak and holly striped plydeck with non-slip varnish with carpet under table.

**Galley**

Located to Port and Aft of the main saloon. Corian worktop with twin stainless steel sinks with hot and cold pressurised water mixer tap. Manually pump fresh water tap. Gimballed Plastimo Neptune 2000 gas cooker with fiddles, two burners, grill and oven. Removeable Corian insert above cooker well. Galley crash bar fitted. Cool box with chopping board lid. Isotherm front opening refrigerator with ice box. Drawers.



**Itchenor Brokerage Limited**

Northshore Boatyard

Itchenor

Chichester

West Sussex

PO20 7AY

[www.itchenorbrokerage.com](http://www.itchenorbrokerage.com)

[sales@itchenorbrokerage.com](mailto:sales@itchenorbrokerage.com)

John Warne: ☎ +44 (0)7562 097230 📧 [john@itchenorbrokerage.com](mailto:john@itchenorbrokerage.com)

Adrian Webb: ☎ + 44 (0)7904 600121 📧 [adrian@itchenorbrokerage.com](mailto:adrian@itchenorbrokerage.com)

Cupboards and crockery stowage. Floor in teak and holly striped plydeck with non-slip varnish.

#### Navigation Area

Located to starboard in the wheelhouse. Inside steering position with Raymarine joystick control. Chart table with storage under and hinged extension piece. Helmsmans seat with stainless steel grabrail. Large hanging locker under. Windscreen wiper for inside steering position.

#### Toilet

Enclosed compartment to starboard with a manual marine W.C., washbasin with pressurised hot and cold water and shower. Stowage lockers, oilskin hanging space adjacent. Mirror and glass holder. Shower grating on floor. Independent electric pump to drain shower tray. Gas water heater.

#### Walk Through

The passageway to the aft cabin incorporates hanging space aft. Access to the engine compartment with two large removeable panels. Doors at galley end and aft cabin end of the walk through.

#### Aft Cabin

Large double berth with three overhead lockers aft. Hanging locker to starboard with drawers and vanity table. Upholstered seat to port with lockers. Opening hatch giving access to aft deck. Opening coaming windows and hull windows fitted with curtains. The floor is finished in carpet. Access to stern gear under floor.

#### **DISCLAIMER:**

The company offers the details of this vessel in good faith but cannot guarantee or warrant the accuracy of this information nor warrant the condition of the vessel. A buyer should instruct his agents or his surveyors, to investigate such details and the buyer desires validated. This vessel is offered subject to prior sale, price change, or withdrawal without notice.



**Itchenor Brokerage Limited**

Northshore Boatyard

Itchenor

Chichester

West Sussex

PO20 7AY

[www.itchenorbrokerage.com](http://www.itchenorbrokerage.com)

[sales@itchenorbrokerage.com](mailto:sales@itchenorbrokerage.com)

John Warne: ☎ +44 (0)7562 097230 📧 [john@itchenorbrokerage.com](mailto:john@itchenorbrokerage.com)  
Adrian Webb: ☎ + 44 (0)7904 600121 📧 [adrian@itchenorbrokerage.com](mailto:adrian@itchenorbrokerage.com)

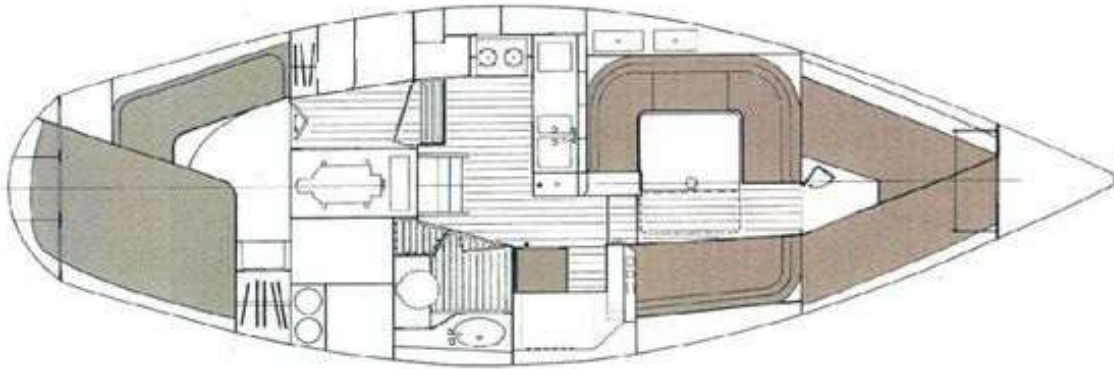



**Itchenor Brokerage Limited**

Northshore Boatyard

Itchenor

Chichester

West Sussex

PO20 7AY

[www.itchenorbrokerage.com](http://www.itchenorbrokerage.com)

[sales@itchenorbrokerage.com](mailto:sales@itchenorbrokerage.com)

John Warne: ☎ +44 (0)7562 097230 📧 [john@itchenorbrokerage.com](mailto:john@itchenorbrokerage.com)

Adrian Webb: ☎ + 44 (0)7904 600121 📧 [adrian@itchenorbrokerage.com](mailto:adrian@itchenorbrokerage.com)



Itchenor Brokerage Ltd., Company No. 16230088

Registered office address: 71-75 Sheldon Street, Covent Garden, London, WC2H 9JQ

Southerly Marine is a registered trademark of Itchenor Brokerage Ltd



**Itchenor Brokerage Limited**

Northshore Boatyard

Itchenor

Chichester

West Sussex

PO20 7AY

[www.itchenorbrokerage.com](http://www.itchenorbrokerage.com)

[sales@itchenorbrokerage.com](mailto:sales@itchenorbrokerage.com)

John Warne: ☎ +44 (0)7562 097230 📧 [john@itchenorbrokerage.com](mailto:john@itchenorbrokerage.com)

Adrian Webb: ☎ + 44 (0)7904 600121 📧 [adrian@itchenorbrokerage.com](mailto:adrian@itchenorbrokerage.com)



Itchenor Brokerage Ltd., Company No. 16230088

Registered office address: 71-75 Sheldon Street, Covent Garden, London, WC2H 9JQ

Southerly Marine is a registered trademark of Itchenor Brokerage Ltd



**Itchenor Brokerage Limited**

Northshore Boatyard

Itchenor

Chichester

West Sussex

PO20 7AY

[www.itchenorbrokerage.com](http://www.itchenorbrokerage.com)

[sales@itchenorbrokerage.com](mailto:sales@itchenorbrokerage.com)

John Warne: ☎ +44 (0)7562 097230 📧 [john@itchenorbrokerage.com](mailto:john@itchenorbrokerage.com)  
Adrian Webb: ☎ + 44 (0)7904 600121 📧 [adrian@itchenorbrokerage.com](mailto:adrian@itchenorbrokerage.com)





**Itchenor Brokerage Limited**  
Northshore Boatyard  
Itchenor  
Chichester  
West Sussex  
PO20 7AY

[www.itchenorbrokerage.com](http://www.itchenorbrokerage.com)  
[sales@itchenorbrokerage.com](mailto:sales@itchenorbrokerage.com)

John Warne: ☎ +44 (0)7562 097230 📧 [john@itchenorbrokerage.com](mailto:john@itchenorbrokerage.com)  
Adrian Webb: ☎ + 44 (0)7904 600121 📧 [adrian@itchenorbrokerage.com](mailto:adrian@itchenorbrokerage.com)





**Itchenor Brokerage Limited**

Northshore Boatyard

Itchenor

Chichester

West Sussex

PO20 7AY

[www.itchenorbrokerage.com](http://www.itchenorbrokerage.com)

[sales@itchenorbrokerage.com](mailto:sales@itchenorbrokerage.com)

John Warne: ☎ +44 (0)7562 097230 📧 [john@itchenorbrokerage.com](mailto:john@itchenorbrokerage.com)

Adrian Webb: ☎ + 44 (0)7904 600121 📧 [adrian@itchenorbrokerage.com](mailto:adrian@itchenorbrokerage.com)



Itchenor Brokerage Ltd., Company No. 16230088

Registered office address: 71-75 Sheldon Street, Covent Garden, London, WC2H 9JQ

Southerly Marine is a registered trademark of Itchenor Brokerage Ltd



**Itchenor Brokerage Limited**

Northshore Boatyard

Itchenor

Chichester

West Sussex

PO20 7AY

[www.itchenorbrokerage.com](http://www.itchenorbrokerage.com)

[sales@itchenorbrokerage.com](mailto:sales@itchenorbrokerage.com)

John Warne: ☎ +44 (0)7562 097230 📧 [john@itchenorbrokerage.com](mailto:john@itchenorbrokerage.com)

Adrian Webb: ☎ + 44 (0)7904 600121 📧 [adrian@itchenorbrokerage.com](mailto:adrian@itchenorbrokerage.com)



Itchenor Brokerage Ltd., Company No. 16230088

Registered office address: 71-75 Sheldon Street, Covent Garden, London, WC2H 9JQ

Southerly Marine is a registered trademark of Itchenor Brokerage Ltd